

DESIGNATION	Acres	Units/Ac.	Total Units
NEIGHBORHOOD "A"	300.4	2.96	890
50' Lots	197.3	4.55	1770
65' Lots	100.3	3.16	319
75' Lots	77.7	2.96	232
85' Lots	45.0	2.06	101
100' Lots	30.1	1.73	52
Elementary School	14.1	—	—
YMCA	12.5	—	—
Retail	18.4	—	—
NEIGHBORHOOD "B"	108.2	6.10	660
50' Lots	55.8	4.43	251
65' Lots	34.4	3.76	131
Apartment	28.8	12.00	340
Retail	6.3	—	—
Office	4.4	—	—
Church	14.7	—	—
NEIGHBORHOOD "C"	240.7	3.90	723
75' Lots	165.2	2.41	232
65' Lots	66.7	2.22	148
100' Lots	56.9	1.89	97
Apartment	30.9	12.00	361
NEIGHBORHOOD "D"	113.4	4.33	491
Town Center	13.2	8.29	110
Town Neighborhood Dev	100.2	3.74	372
NEIGHBORHOOD "E"	216.7	5.27	1136
50' Lots	147.7	4.49	662
65' Lots	64.4	3.33	215
75' Lots	29.4	3.06	90
Apartment	12.8	12.75	163
Actual & Adopted Using	8.9	14.04	125
PROPOSED PONDS	88.1	TOTAL RES. UNITS*	3899
NATURAL AREAS, BUFFERS, LAKES TURNED WEST ANGLES (areas not included above)	317.6	UNITS/ACRE*	2.73
TOTAL (AC.)	1429.4		

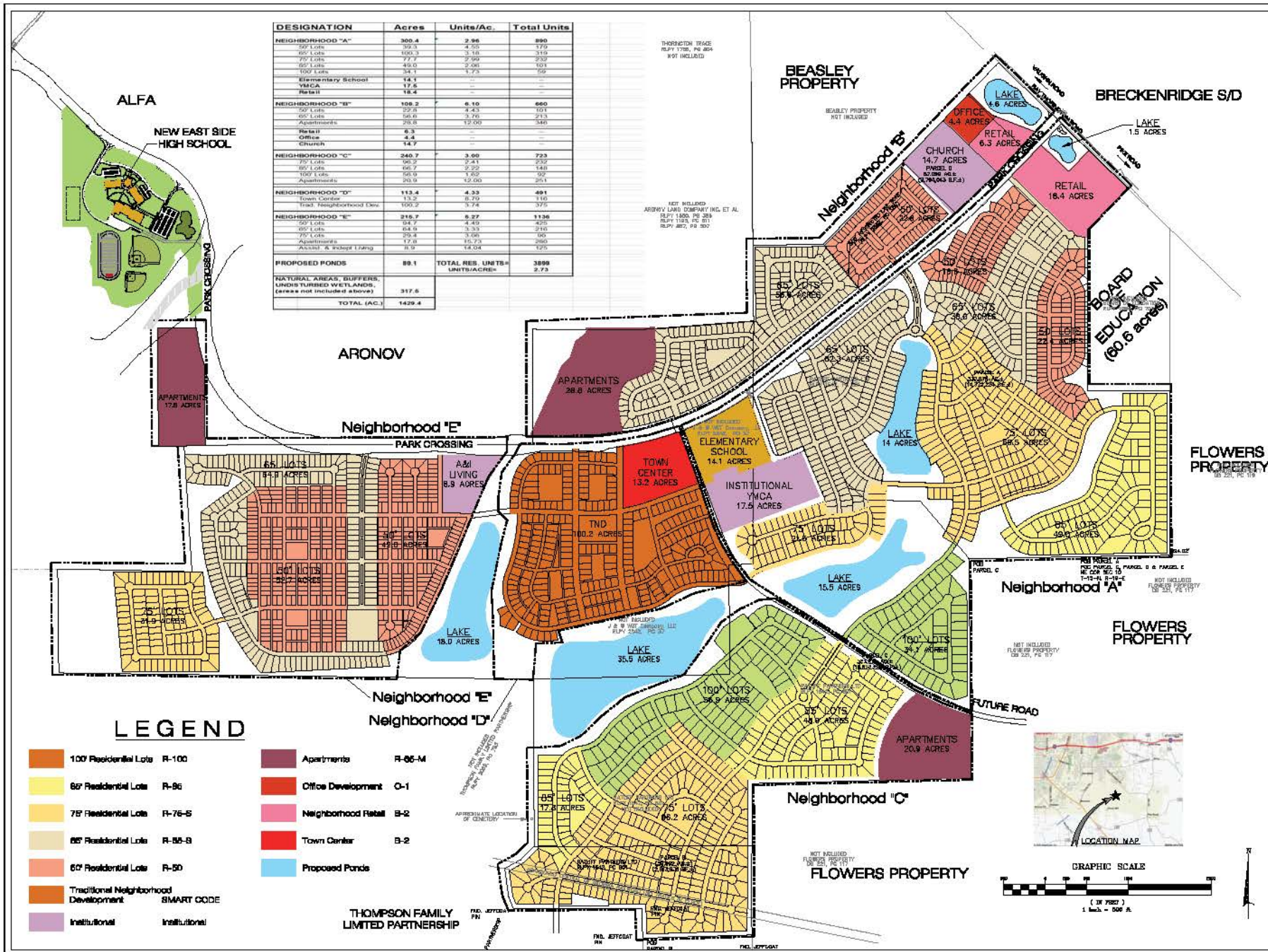

LEGEND

- 100' Residential Lots R-100
- 65' Residential Lots R-66
- 75' Residential Lots R-76-S
- 65' Residential Lots R-65-B
- 50' Residential Lots R-50
- Traditional Neighborhood Development SMART CODE
- Institutional Institutional
- Apartments R-65-M
- Office Development O-1
- Neighborhood Retail B-2
- Town Center B-2
- Proposed Ponds



GOODWYN MILLS CAWOOD

3640 EastChamblee Lane, Suite 200 | Montgomery, AL 36117
Tel: 354-377-3300 | info@mcmt.com

ISSUE DATE

REVISED PLAN

DATE

BY

CHECKED BY

NEW PARK OVERALL MASTER PLAN

REVISIONS

JIM WILSON & ASSOCIATES, INC.

OVERALL MASTER PLAN

C1